

Wireless Vibration Detector / Sensore Vibrazioni via Radio



Model/Modello: EL-4807



Installation and User Guide / Manuale Utente e Installatore

EN Introduction

The EL-4807 is a 1 & 2-Way wireless vibration detector for use with security systems.

Installation

Mounting the Vibration Detector

1. Open the vibration detector housing (see Figure 1).
2. Mount the back cover (see Figure 2).

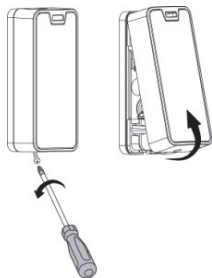

Figure 1

Vibration Detector Settings

SW1	Mode	Description
	2-Way	ON
	1-Way	OFF

Potentiometer (1-way)

When using the system, set the sensitivity of the vibration detector using the potentiometer. Turn the potentiometer clockwise to increase the detector sensitivity or counter-clockwise to reduce the sensitivity (see Figure 3).

Note: To use the back tamper, the back tamper screw must be installed.

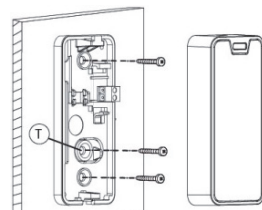

Figure 2

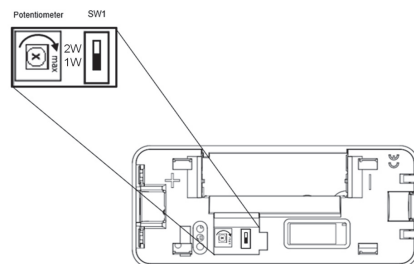

Figure 3

A. Registration to 2-Way Panel

The EL-4807 must identify itself to the panel's receiver as follows:

1. Set the system to registration mode.
 - a. Go to the main menu and select [9]>[1]>[1] (Programming > Devices > Zones).
 - b. Select a zone and press 'v'.
2. Open the detector housing.
3. Remove the divider separating the battery from the contacts on the battery holder. The detector will send a transmission. If the transmission is successfully received by the system it will play a confirmation sound. If no confirmation sound is heard send another transmission by pressing and releasing the tamper switch of the device.
4. As soon as 'Save?' appears press 'v'.

Quick Registration to 2-Way Panel (If Quick Registration is enabled)

1. At the control panel, press and hold for about 3 seconds (disregard the ENTER USER CODE message) until REGISTER and TRANSMIT display.
2. Open the detector housing.
3. Remove the divider separating the battery from the contacts on the battery holder. The detector will send a transmission. If the transmission is successfully received by the system it will play a confirmation sound. If no confirmation sound is heard, send another transmission by pressing and releasing the tamper switch of the device.
4. As soon as 'Save?' appears press 'v'.

B. Registration to 1-Way Panel

1. Set the system to registration mode.
 - a. Go to the main menu and select [9]>[1]>[1] (Programming > Devices > Zones).
 - b. Select a zone and press 'v'.
2. Open the detector housing.
3. Remove the battery protector strip; TRANSMIT 2 displays.
4. Press the transmitter's tamper switch and then release it; the (automatically generated) zone number and SAVE? display.
5. Press 'v' to save the registration, or press 'X' to cancel.

Quick Registration to 1-Way Panel (If Quick Registration is enabled)

1. At the control panel, press and hold for about 3 seconds until REGISTER and TRANSMIT display.
2. Remove the battery protector strip; TRANSMIT 2 displays.
3. Press the transmitter's tamper switch and then release it; the (automatically generated) zone number and SAVE? display.
4. Press 'v' to save the registration, or press 'X' to cancel.

Deleting a Vibration Detector from 2-Way Panel

To delete a vibration detector from the system:

1. Set the system to Delete mode.
 - a. Go to the main menu and select [9]>[1]>[1] (Programming > Devices > Zones).
 - b. Select a zone and press 'v'.
2. Press >12>v.
3. Open the detector and take out the battery.
4. Close and hold the tamper switch.
5. Insert the battery (while the tamper is being pressed).
6. Within 5 seconds, open the tamper and close it again.

Quick Deletion from 2-Way Panel (If Quick Deletion is enabled)

1. At the control panel, press and hold the X button for about 3 seconds until DELETE! display.
2. Open the detector's tamper switch.
3. Press 'v' to delete the transmitter, or press 'X' to cancel.

Deleting a Vibration Detector from 1-Way Panel

To delete a vibration detector from the system:

1. Set the system to Delete mode.
 - a. Go to the main menu and select [9]>[1]>[1] (Programming > Devices > Zones).
 - b. Select a zone and press 'v'.
2. Press >9>v.

Quick Deletion from 1-Way Panel (If Quick Deletion is enabled)

1. At the control panel, press and hold the X button for about 3 seconds until DELETE and TRANSMIT 1 display.
2. Press the transmitter's tamper switch; DELETE OK? Displays.
3. Press 'v' to delete the transmitter, or press 'X' to cancel.

Parameters Setting via (2-Way) Panel

As a 2-Way detector, the EL-4807 parameters can be modified only from the panel's receiver.

The parameter settings can be defined as follows:

1. Go to the main menu and select [9]>[1]>[1]>[11] (Programming > Devices > Zones > Sensor Par.)
2. Select Sensitivity and define the parameter accordingly (1 – 100), 1 being the lowest, 100 the highest.

Testing a Vibration Detector

Once you have mounted the detector, test the detector's sensitivity, as follows:

1. With the detector housing open, strike the protected door or window at the furthest point away from the detector with a screwdriver handle or cushioned tool; the flashing LED color indicates the sensitivity level of the detector. Refer to following table:

RED	Under-sensitive indication
GREEN	Normal sensitivity (recommended)
ORANGE	Over-sensitive indication

2. If required, adjust the Sensitivity parameter.
3. Repeat the sensitivity test until you achieve the required sensitivity level.

4. After you have adjusted the sensitivity parameter, repeat the test once more.
5. Close the front cover of the detector.

Note: The same LED behavior is applicable during normal operation mode of the vibration sensor.

Technical Specification

Power	3V Lithium Battery, CR123A
Expected Battery Life	3 Years
Current Consumption	30mA (transmission), 10µA (standby)
Power Output	10mW
Operating Temperature	-10 – 55°C (14 – 131°F)
Storage Temperature	-20 – 60°C (-4 – 140°F)
Dimensions	80 x 35 x 22 mm
Frequency	433 MHz, 868 MHz

RED Compliance Statement:

Hereby, RISCO Group declares that this equipment is in compliance with the essential requirements and other relevant provisions of Directive 2014/53/EU. For the CE Declaration of Conformity please refer to our website: www.riscogroup.com.

IT Introduzione

Il trasmettitore EL-4807 è un sensore di vibrazioni via radio che può essere utilizzato con le centrali Electronics Line monodirezionali e bidirezionali.

Installazione

Installazione del Sensore Vibrazioni

1. Aprire il contenitore (vedi Figura 1).



Figura 1

2. Fissare la base al muro (vedi Figura 2).

Selezione del Protocollo Radio del Sensore Vibrazioni

SW1	Modalità	Posizione dip
	Bidirezionale	ON
	Monodirezionale	OFF

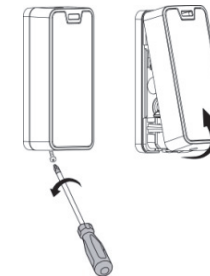
Regolazione sensibilità (Modalità monodirezionale)

Per impostare la sensibilità alle vibrazioni, quando il sensore è utilizzato in modalità monodirezionale, utilizzare il potenziometro. Ruotandolo in senso orario si aumenterà la sensibilità, mentre in senso anti orario si ridurrà. (vedi Figura 3).

Note: Installare la vite posteriore se si desidera utilizzare il tamper antistrappo.



Figura 2



Figura 3

Testare il Sensore Vibrazioni

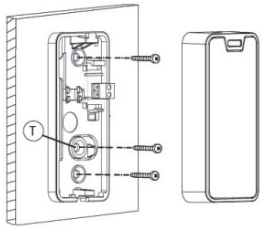
1. Terminata l'installazione, testare il sensore come segue:

Con il guscio del dispositivo aperto, colpire con un oggetto la superficie protetta nel punto più lontano dal dispositivo e verificare la risposta del LED. A seconda del colore mostrato dal LED, avremo una indicazione del livello di sensibilità. La tabella che segue riporta i vari colori:

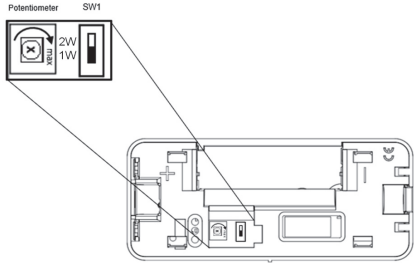
ROSSO	Sensibilità troppo bassa
VERDE	Sensibilità normale (consigliata)
ARANCIO	Sensibilità troppo alta

2. Se necessario, regolare la sensibilità. Ripetere il test finché non si raggiunge la taratura desiderata. Dopo avere raggiunto la taratura desiderata, ripetere il test per conferma.
- Chiudere il dispositivo.

A. Cancellazione del dispositivo (Modalità manuale)

1. Per cancellare il dispositivo in Modalità Manuale:
 - a. Andare al menù [9]>[1]>[1]
 - b. Confermare con '√'.
1. Selezionare >Cancella poi confermare con '√'.

B. Cancellazione del dispositivo (Modalità rapida)

Per cancellare il dispositivo in Modalità rapida:

1. Sulla centrale premere e tenere premuto X per 3 secondi finché vengono mostrati CANCELLA e TRASMISSIONE
2. Premere il tamper del Trasmettitore, verrà mostrato CANCELLA OK?.
3. Premere '√' per cancellare il Trasmettitore (la centrale emetterà un tono acustico e passerà alla cancellazione successiva), o premere X per annullare.

Nota: La stessa logica di attivazione del LED si riscontra durante il normale funzionamento del trasmettitore.

Specifiche Tecniche

Alimentazione	3V Al litio, CR123A
Durata batterie media	3 Anni
Assorbimento	30mA (trasmissione), 10µA (standby)
Potenza di trasmissione	10mW
Temperatura di esercizio	-10 - 55°C (14 - 131°F)
Temperatura di stoccaggio	-20 - 60°C (-4 - 140°F)
Dimensioni	80 x 35 x 22 mm
Frequenza operativa	433 MHz, 868 MHz

Dichiarazione di Conformità RED:

La sottoscritta RISCO Group, dichiara sotto la propria responsabilità che questo prodotto è conforme ai requisiti essenziali e alle altre rilevanti disposizioni della Direttiva Europea 2014/53/EU.

Per le Dichiarazioni di Conformità CE, visitate il nostro sito web: www.riscogroup.com

A. Memorizzazione (modalità Manuale)

1. Per memorizzare il trasmettitore utilizzando la modalità manuale di apprendimento:
2. Impostare la centrale in modalità "Memorizzazione".
 - a. Dal menù principale premere [9]>[1]>[1] (Menù Install. > Prog. Dispositivi > Zone)
 - b. Selezionare una Zona confermando su di essa con '√'.
3. Aprire il guscio del dispositivo.
4. Rimuovere la protezione dalla batteria. Il dispositivo invierà un impulso di scrittura, se ricevuto correttamente la centrale emetterà un suono di conferma. Se non viene riprodotto un tono di conferma premere il tamper del dispositivo per ri inviare il messaggio.
5. Verrà mostrato il messaggio SALVA? Confermare con '√'.

B. Memorizzazione (Modalità rapida)

1. Per memorizzare il trasmettitore utilizzando la modalità rapida di apprendimento:
2. Sulla centrale, premere e tenere premuto '√' per 3 secondi finché vengono mostrati REGISTRAZ. e TRASMISSIONE 1.
3. Rimuovere la protezione dalla batteria (vedi figura 3); verranno mostrati REGISTRAZ e TRASMISSIONE 2.
4. NOTA: La seconda trasmissione viene richiesta solo in caso si usi il sistema monodirezionale SecuPlace
5. Verrà mostrato sul display il numero di zona al quale il dispositivo è stato assegnato ed il messaggio SALVA? Se ciò non avviene, premere e rilasciare il tamper per inviare un altro messaggio di scrittura.
6. Premere '√' per confermare la memorizzazione (la centrale emetterà un tono acustico e passerà alla memorizzazione successiva) o premere X per annullare.

Regolazione sensibilità (Modalità bidirezionale)

1. Quando utilizzato in modalità bidirezionale, il sensore vibrazioni EL-4807 permette di regolare la sensibilità tramite tastiera, per farlo:
 - a. Andare al menù [9]>[1]>[1]>[11] (Menu Install. > Prog. Dispositivi > Zone>Scegliere la zona e andare su Param. Sens.)
2. Impostare la sensibilità alle vibrazioni (1 - 100), 1 indica una minore sensibilità e 100 la maggiore.

Standard Limited Product Warranty ("Limited Warranty")

RISCO Ltd. ("RISCO") guarantee RISCO's hardware products ("Products") to be free from defects in materials and workmanship when used and stored under normal conditions and in accordance with the instructions for use supplied by RISCO, for a period of (i) 24 months from the date of delivery of the Product (the "Warranty Period"). This Limited Warranty covers the Product only within the country where the Product was originally purchased and only covers Products purchased as new.

Contact with customers only. This Limited Warranty is solely for the benefit of customers who purchased the Products directly from RISCO or from an authorized distributor of RISCO. RISCO does not warrant the Product to consumers and nothing in this Warranty obligates RISCO to accept Product returns directly from end users who purchased the Products for their own use from RISCO's customer or from any installer of RISCO, or otherwise provide warranty or other services to any such end user directly. RISCO's authorized distributor or installer shall handle all interactions with its end users in connection with this Limited Warranty. RISCO's authorized distributor or installer shall make no warranties, representations, guarantees or statements to its end users or other third parties that suggest that RISCO has any warranty or service obligation to, or any contractual privity with, any recipient of a Product.

Remedies. In the event that a material defect in a Product is discovered and reported to RISCO during the Warranty Period, RISCO shall accept return of the defective Product in accordance with the below RMA procedure and, at its option, either (i) repair or have repaired the defective Product, or (ii) provide a replacement product to the customer.

Return Material Authorization. In the event that you need to return your Product for repair or replacement, RISCO will provide you with a Return Merchandise Authorization Number (RMA#) as well as return instructions. Do not return your Product without prior approval from RISCO. Any Product returned without a valid RMA# will be refused and returned to the sender at the sender's expense. The returned Product must be accompanied with a detailed description of the defect discovered ("Defect Description") and must otherwise follow RISCO's then-current RMA procedure published in RISCO's website at www.riscogroup.com in connection with any such return. If RISCO determines in its reasonable discretion that any Product returned by customer conforms to the applicable warranty ("Non-Defective Product"), RISCO will notify the customer of such determination and will return the applicable Product to customer at customer's expense. In addition, RISCO may propose and assess customer a charge for testing and examination of Non-Defective Product.

Entire Liability. The repair or replacement of Products in accordance with this Limited Warranty shall be RISCO's entire liability and customer's sole and exclusive remedy in case a material defect in a Product is discovered and reported as required herein. RISCO's obligation and this Limited Warranty are contingent upon the full payment by customer for such Product and upon a proven weekly testing and examination of the Product functionality.

Limitations. This Limited Warranty is the only warranty made by RISCO with respect to the Products. The warranty is not transferable to any third party. To the maximum extent permitted by applicable law, this Limited Warranty shall not apply and will be void if: (i) the conditions set forth above are not met (including, but not limited to, full payment by customer for the Product and a proven weekly testing and examination of the Product functionality); (ii) if the Products or any part or component thereof: (a) have been subjected to improper operation or installation; (b) have been subject to neglect, abuse, willful damage, abnormal working conditions, failure to follow RISCO's instructions (whether oral or in writing); (c) have been misused, altered, modified or repaired without RISCO's written approval or combined with, or installed on products, or equipment of the customer or of any third party; (d) have been damaged by any factor beyond RISCO's reasonable control such as, but not limited to, power failure, electric power surges, or unsuitable third party components and the interaction of software therewith or (e) any failure or delay in the performance of the Product attributable to any means of communication provided by any third party service provider, including, but not limited to, GSM interruptions, lack of internet outage and/or telephony failure. BATTERIES ARE EXPLICITLY EXCLUDED FROM THE WARRANTY AND RISCO SHALL NOT BE HELD RESPONSIBLE OR LIABLE IN RELATION THERETO, AND THE ONLY WARRANTY APPLICABLE THERETO, IF ANY, IS THE BATTERY MANUFACTURER'S WARRANTY. RISCO does not install or integrate the Product in the end user's security system and is therefore not responsible for and cannot guarantee the performance of the end user's security system which uses the Product or which the Product is a component of.

This Limited Warranty applies only to Products manufactured by or for RISCO. Further, this Limited Warranty does not apply to any software (including operating system) added to or provided with the Products or any third-party software, even if packaged or sold with the RISCO Product. Manufacturers, suppliers, or third parties other than RISCO may provide their own warranties, but RISCO, to the extent permitted by law and except as otherwise specifically set forth herein, provides its Products "AS IS". Software and applications distributed or made available by RISCO in conjunction with the Product (with or without the RISCO brand), including, but not limited to system software, as well as P2P services or any other service made available by RISCO in relation to the Product, are not covered under this Limited Warranty. Refer to the Terms of Service at: <https://riscocloud.com/ELAS/WebUI/UserLoginLicense> for details of your rights and obligations with respect to the use of such applications, software or any service. RISCO does not represent that the Product may not be compromised or circumvented; that the Product will prevent any personal injury or property loss by burglary, robbery, fire or otherwise, or that the Product will in all cases provide adequate warning or protection. A properly installed and maintained alarm may only reduce the risk

of a burglary, robbery or fire without warning, but it is not insurance or a guarantee that such will not occur or will not cause or lead to personal injury or property loss. CONSEQUENTLY, RISCO SHALL HAVE NO LIABILITY FOR ANY PERSONAL INJURY, PROPERTY DAMAGE OR OTHER LOSS BASED ON ANY CLAIM AT ALL INCLUDING A CLAIM THAT THE PRODUCT FAILED TO GIVE WARNING.

EXCEPT FOR THE WARRANTIES SET FORTH HEREIN, RISCO AND ITS LICENSORS HEREBY DISCLAIM ALL EXPRESS, IMPLIED OR STATUTORY, REPRESENTATIONS, WARRANTIES, GUARANTEES, AND CONDITIONS WITH REGARD TO THE PRODUCTS, INCLUDING BUT NOT LIMITED TO ANY REPRESENTATIONS, WARRANTIES, GUARANTEES, AND CONDITIONS OF MERCHANTABILITY, FITNESS FOR A PARTICULAR PURPOSE, TITLE AND WARRANTIES AGAINST HIDDEN OR LATENT DEFECTS. TO THE EXTENT PERMITTED BY LAW, WITHOUT LIMITING THE GENERALITY OF THE FOREGOING RISCO AND ITS LICENSORS DO NOT REPRESENT OR WARRANT THAT: (I) THE OPERATION OR USE OF THE PRODUCT WILL BE TIMELY, SECURE, UNINTERRUPTED OR ERROR-FREE; (ii) THAT ANY FILES, CONTENT OR INFORMATION OF ANY KIND THAT MAY BE ACCESSED THROUGH THE PRODUCT SHALL REMAIN SECURED OR NON DAMAGED. CUSTOMER ACKNOWLEDGES THAT NEITHER RISCO NOR ITS LICENSORS CONTROL THE TRANSFER OF DATA OVER COMMUNICATIONS FACILITIES, INCLUDING THE INTERNET, GSM OR OTHER MEANS OF COMMUNICATIONS AND THAT RISCO'S PRODUCTS, MAY BE SUBJECT TO LIMITATIONS, DELAYS, AND OTHER PROBLEMS INHERENT IN THE USE OF SUCH MEANS OF COMMUNICATIONS. RISCO IS NOT RESPONSIBLE FOR ANY DELAYS, DELIVERY FAILURES, OR OTHER DAMAGE RESULTING FROM SUCH PROBLEMS. RISCO WARRANTS THAT ITS PRODUCTS DO NOT, TO THE BEST OF ITS KNOWLEDGE, INFRINGE UPON ANY PATENT, COPYRIGHT, TRADEMARK, TRADE SECRET OR OTHER INTELLECTUAL PROPERTY RIGHT IN ANY EVENT RISCO SHALL NOT BE LIABLE FOR ANY AMOUNTS REPRESENTING LOST REVENUES OR PROFITS, PUNITIVE DAMAGES, OR FOR ANY OTHER INDIRECT, SPECIAL, INCIDENTAL, OR CONSEQUENTIAL DAMAGES, EVEN IF THEY WERE FORESEEABLE OR RISCO HAS BEEN INFORMED OF THEIR POTENTIAL.

Contacting RISCO Group

RISCO Group is committed to customer service and product support. You can contact us through our website www.riscogroup.com or via the following:

Belgium (Benelux) Tel: +32-2522-7622 support-be@riscogroup.com	France Tel: +33-164-73-28-50 support-fr@riscogroup.com
China (Shanghai) Tel: +86-21-52-39-0066 support-cn@riscogroup.com	Israel Tel: +972-3-963-7777 support@riscogroup.com
Spain Tel: +34-91-490-2133 support-es@riscogroup.com	Italy Tel: +39-02-66590054 support-it@riscogroup.com
USA Tel: +1-631-719-4400 support-usa@riscogroup.com	United Kingdom Tel: +44-(0)-161-655-5500 support-uk@riscogroup.com

This RISCO product was purchased at:



All rights reserved. No part of this document may be reproduced in any form without prior written permission from the publisher.

© RISCO Group 09/18

5IN2723 D